



Audi

ETKA

Model	Year	MG	SG	Illustration	Restrictions	UPD	8:53	17.06.2015
A6Q	2001	1	09	109-044		1071		

EC	TC	VIN	Sales Type
ANK	FBD	WAUZZZ4BZ1N077875	4B604Z

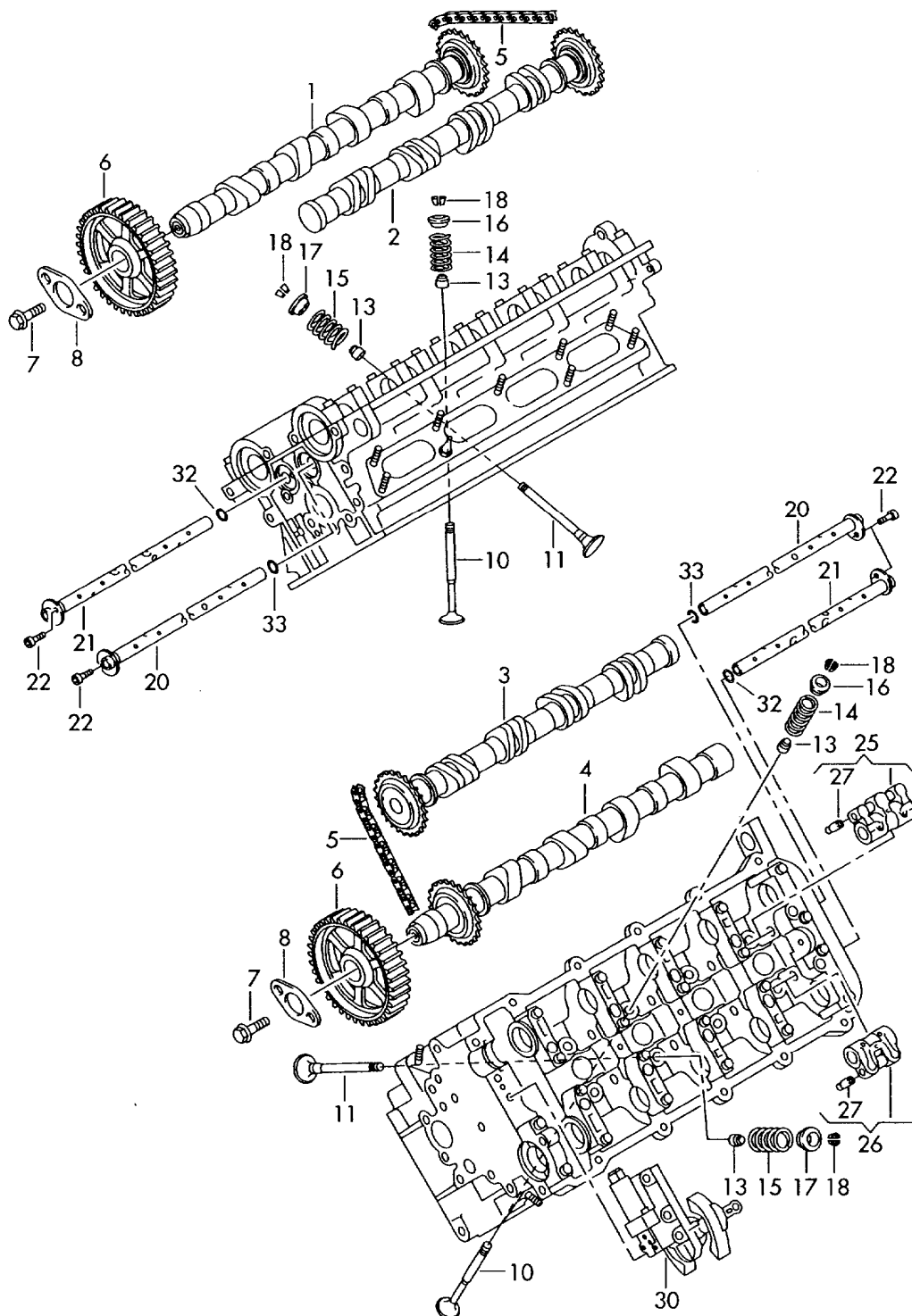



Audi

ETKA

Model	Year	MG	SG	Illustration	Restrictions	UPD	8:53	17.06.2015
A6Q	2001	1	09	109-044		1071		

EC	TC	VIN	Sales Type
ANK	FBD	WAUZZZ4BZ1N077875	4B604Z

Pos	Part Number	Description	Remark	Qty	Model
		camshaft, valves	4.2 ltr.		8-cylinder: ARS,AQJ,ASG, ANK
1	077 109 022 CA	camshaft	outlet cylinders 1-4	1	ARS,ASG
(1)	077 109 022 DP	camshaft	outlet cylinders 1-4	1	AQJ,ANK
(2)	077 109 021 GM	camshaft	inlet cylinders 1-4	1	ARS,ASG
(2)	077 109 021 FQ	camshaft	inlet cylinders 1-4	1	AQJ,ANK
3	077 109 021 GK	camshaft	inlet cylinder 5-8	1	ARS,ASG
(3)	077 109 021 FR	camshaft	inlet cylinder 5-8	1	AQJ,ANK
4	077 109 022 EL	camshaft	outlet cylinder 5-8	1	ARS,ASG
(4)	077 109 022 DE	camshaft	outlet cylinder 5-8	1	AQJ,ANK
5	058 109 229 B	camshaft timing chain		2	
6	078 109 111 B	toothed belt pulley		2	
7	N 906 371 01	hexagon bolt	M10X1X145X45	2	
8		adjusting washer see illustration:	109-94		
10	077 109 601 Q	inlet valve		24	
(11)	077 109 611 S	exhaust valve		16	
(13)	036 109 675 A	valve stem seal	6MM	40	
14	077 109 633 A	valve spring for intake valve		24	ARS,ASG
(14)	077 109 633 F	valve spring for intake valve		24	AQJ,ANK
15	077 109 623 C	valve spring for exhaust valve		16	
16	077 109 641 G	spring disc for intake valve	upper	24	



Audi

ETKA

Model	Year	MG	SG	Illustration	Restrictions	UPD	8:53	17.06.2015
A6Q	2001	1	09	109-044		1071		

EC	TC	VIN	Sales Type
ANK	FBD	WAUZZZ4BZ1N077875	4B604Z

Pos	Part Number	Description	Remark	Qty	Model
17	077 109 641 H	spring disc for exhaust valve	upper	16	
18	036 109 651 A	cotter, split		80	
20	077 109 371 C	axle		2	
21	077 109 372 C	axle		2	
22	N 101 961 03	socket head bolt with inner multipoint head (kombi)	M6X18	4	
25	077 109 417 J	roller rocker arm		4	ARS,ASG
(25)	077 109 417 N	roller rocker arm		4	AQJ,ANK
26	077 109 417 K	roller rocker arm		4	ARS,ASG
(26)	077 109 417 M	roller rocker arm		4	AQJ,ANK
27	077 109 320 CB	compensating piece		40	
(30)	077 109 088 E	camshaft adjuster unit	cylinders 1-4	1	
(30)	077 109 087 E	camshaft adjuster unit	cylinder 5-8	1	
-	WHT 002 015	socket head bolt with inner multipoint head to be used for item:	30	8	
32	077 133 287 A	o-ring		2	
33	077 133 287 B	o-ring		2	
-	100 109 001 B	mounting sleeve red	6X20	X	
-	D 176 404 A2	silicone sealant	93G	1	
-	077 198 217	gasket set for chain tensioner/camshaft adjuster		1	