

## Removing and installing engine mounting (right-side)

### Special tools and workshop equipment required

- ♦ Support bracket -10 - 222 A-

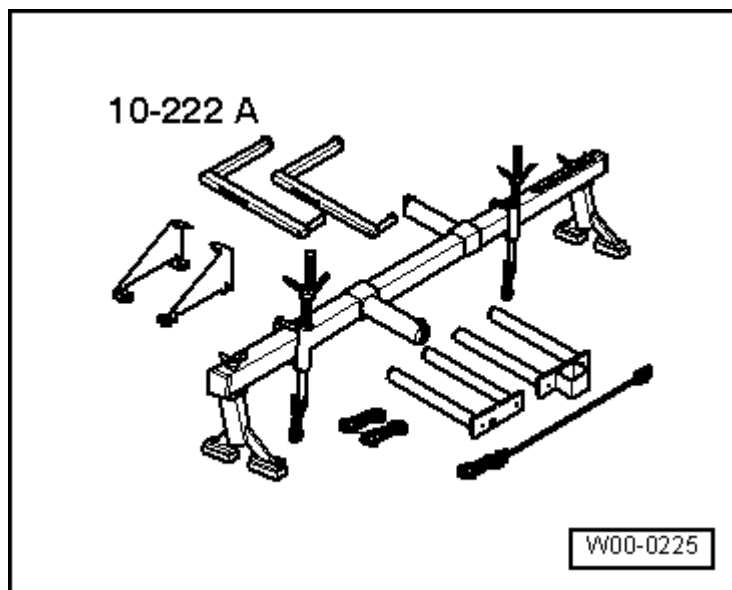

- ♦ Hook -10 - 222 A /10-

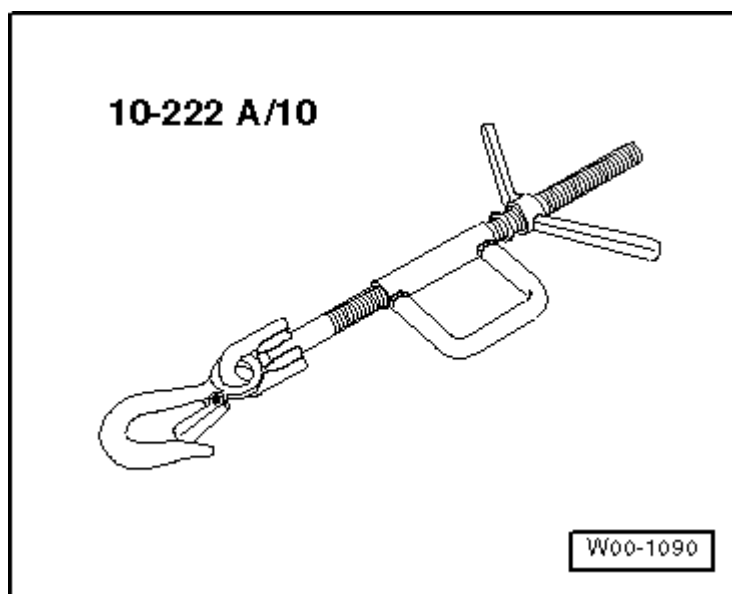

- ♦ Engine support bracket (basic set) - T40091-

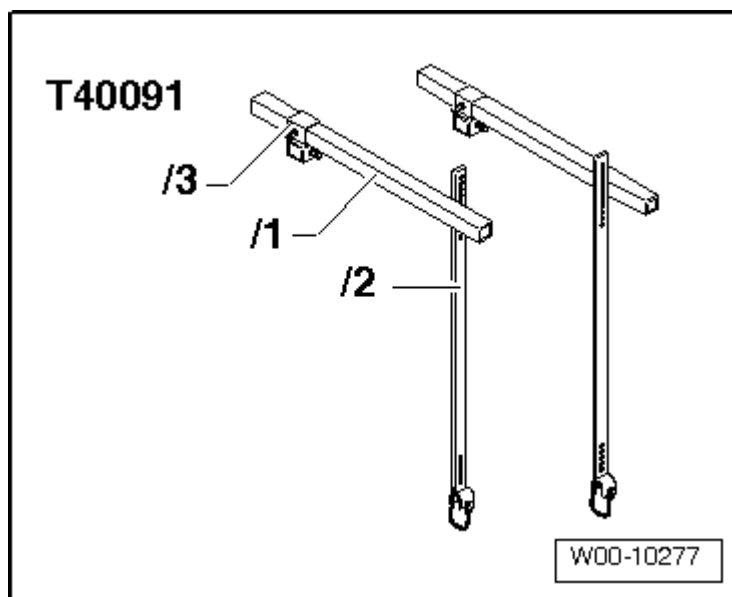

- ♦ Engine support bracket (supplementary set) -T40093-

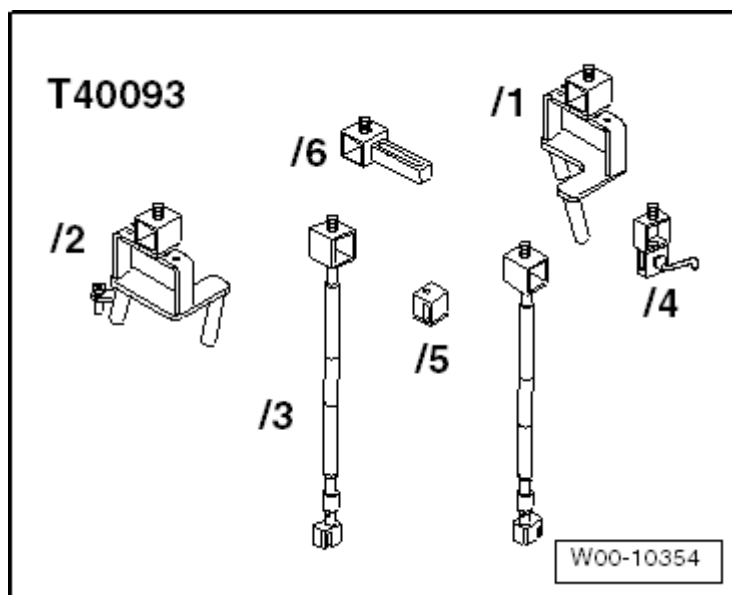

### Removing

- Carefully pull engine cover panel off four retaining pins one after the other -arrows-.
- Remove air cleaner housing →Rep. gr.23.

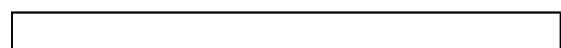
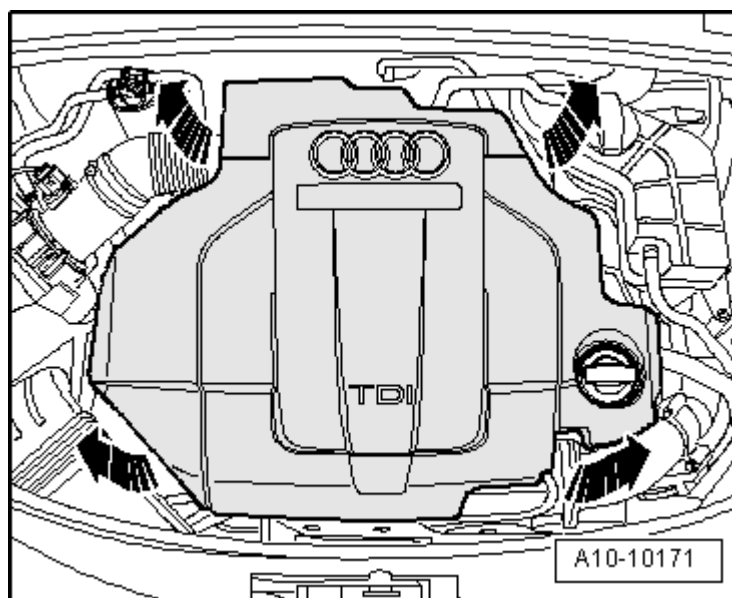



**Caution**

**Observe notes on procedure for disconnecting the battery.**

- With ignition switched off, disconnect battery earth cable -arrow- →Rep. gr.27.

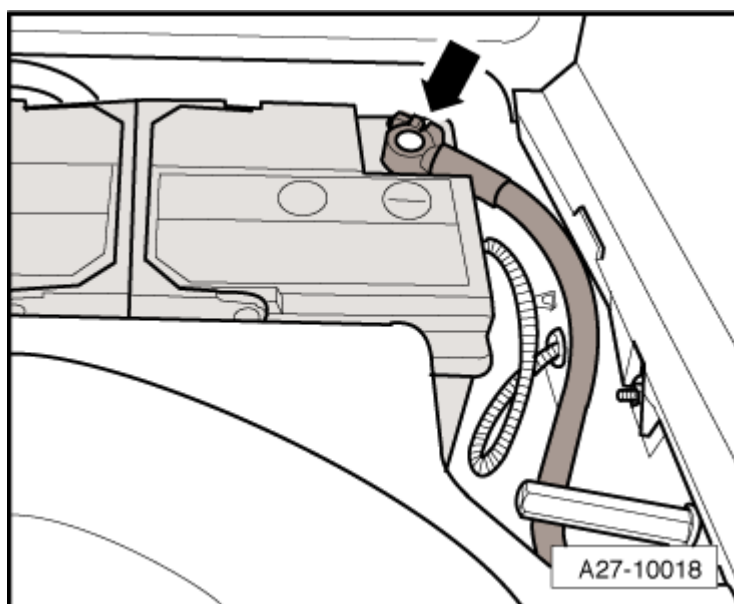

- Pull off seal -1- and remove plenum chamber cover -2-.

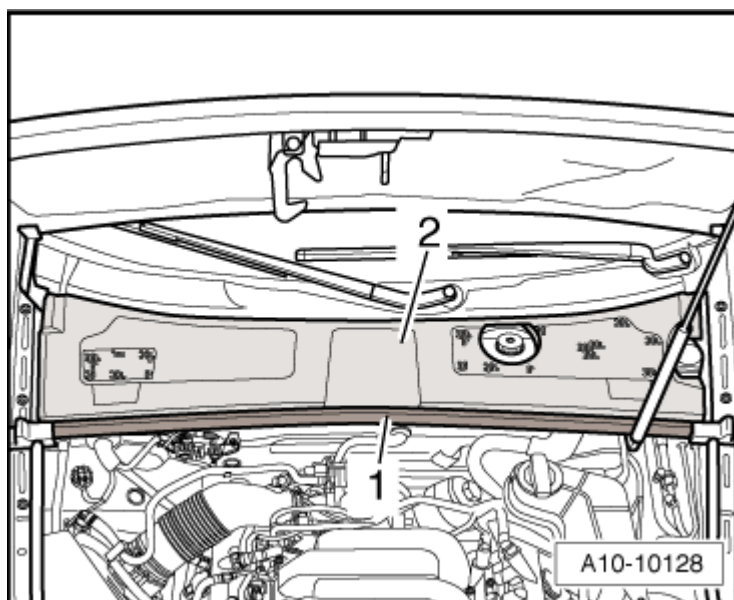

- Set up adapter -10 - 222 A /4- with connecting piece -T40091/3- and supports -T40093/1- and -T40093/2- on suspension turrets.
- Supports are marked for left and right side of vehicle.

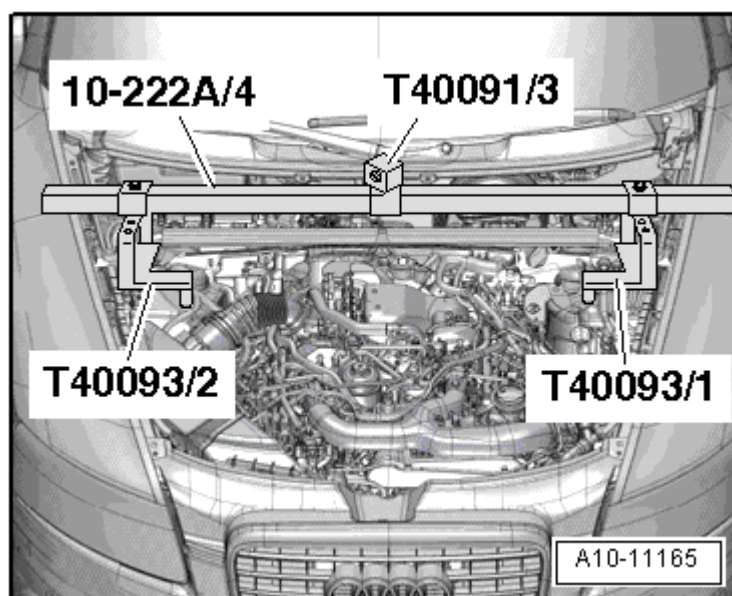

- Attach further components of support bracket -10 - 222 A-, -T40091- and -T40093- as shown in illustration. Position support -T40093/3- onto flange of longitudinal member.
- Engage hook -10 - 222 A /10- at engine lifting eye (left-side).
- Take up weight of engine with spindle.

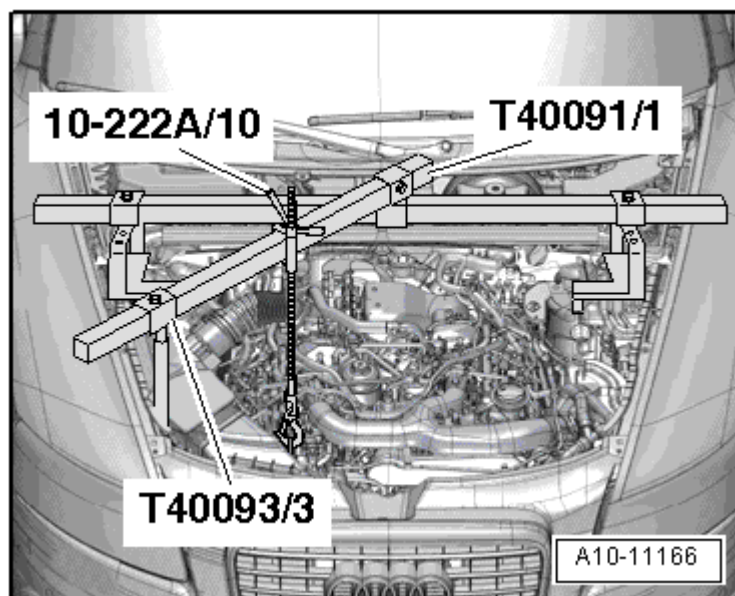

- Remove front right wheel.
- Release fasteners marked -1, 2- and -arrow- (if fitted) and remove front and rear noise insulation.

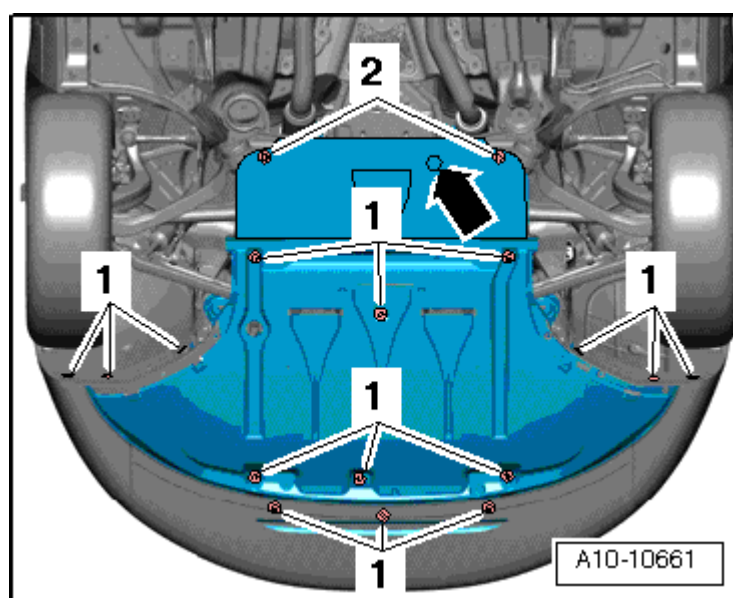

- Unscrew nut -arrow- on longitudinal member (right-side) and move earth cable clear.

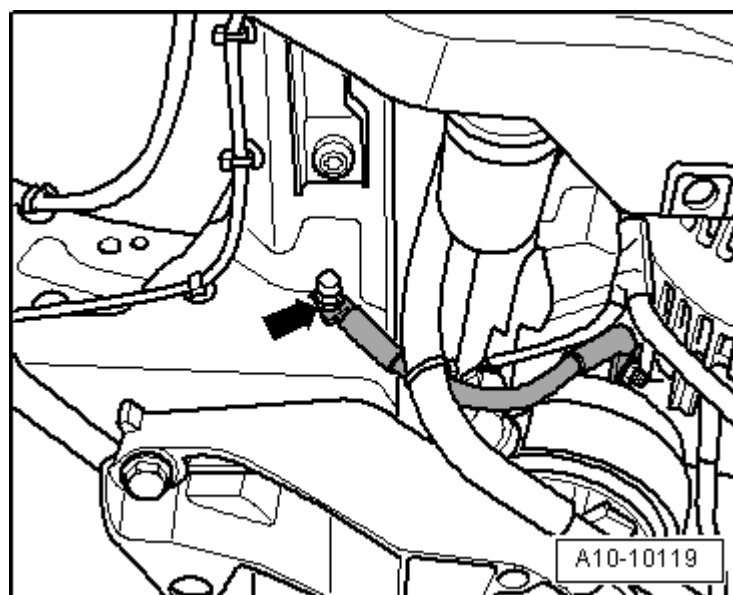

- Remove nuts -1- and -2- for anti-roll bar

mounting on both sides and slightly lower anti-roll bar.

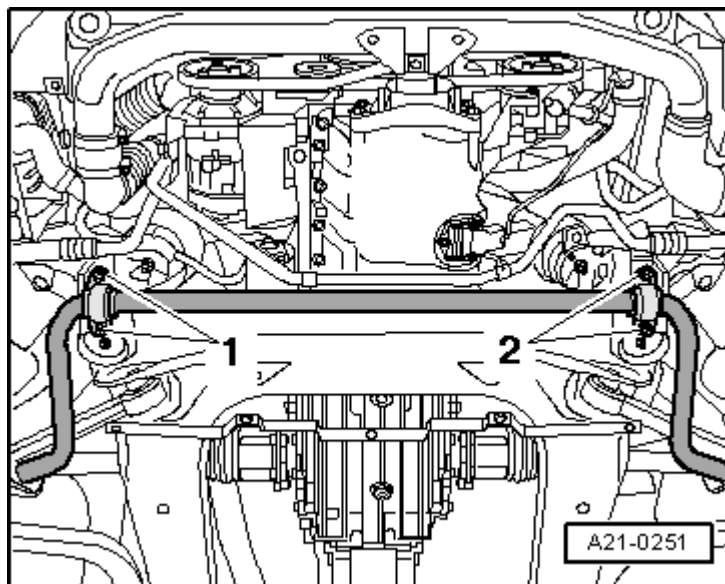

- Remove nut -3-.
- Remove bolts -1- and -2- and take off console for engine mounting (right-side).

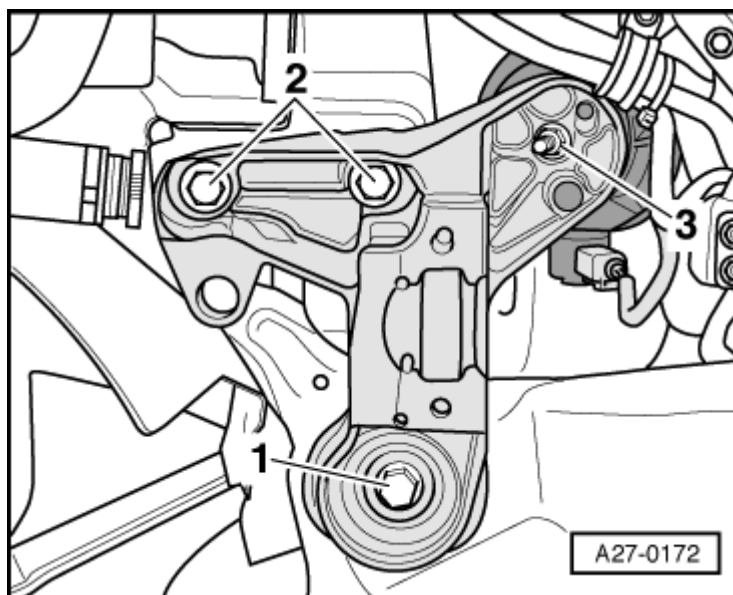

- Remove cover -1- for drive shaft in wheel housing (right-side).

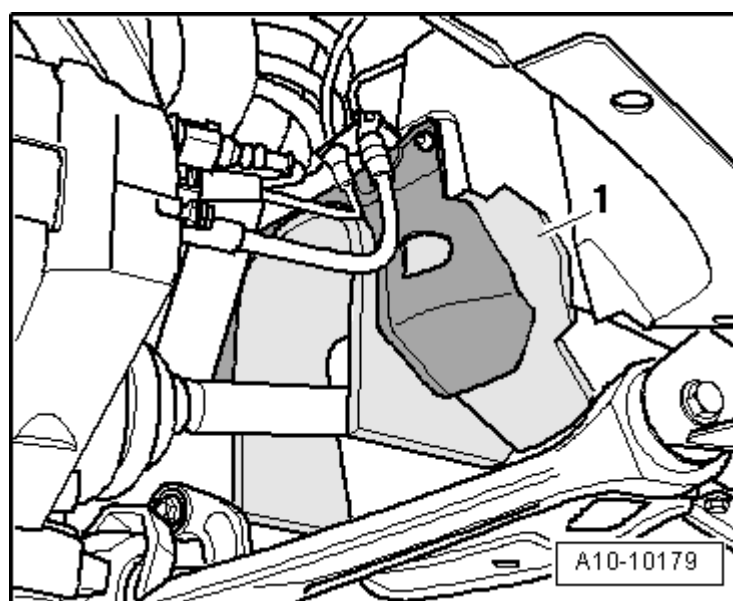

- Unplug electrical connector -1- on right electrohydraulic engine mounting solenoid

valve -N145-.

- Remove bolts -arrows- and detach engine support with engine mounting.

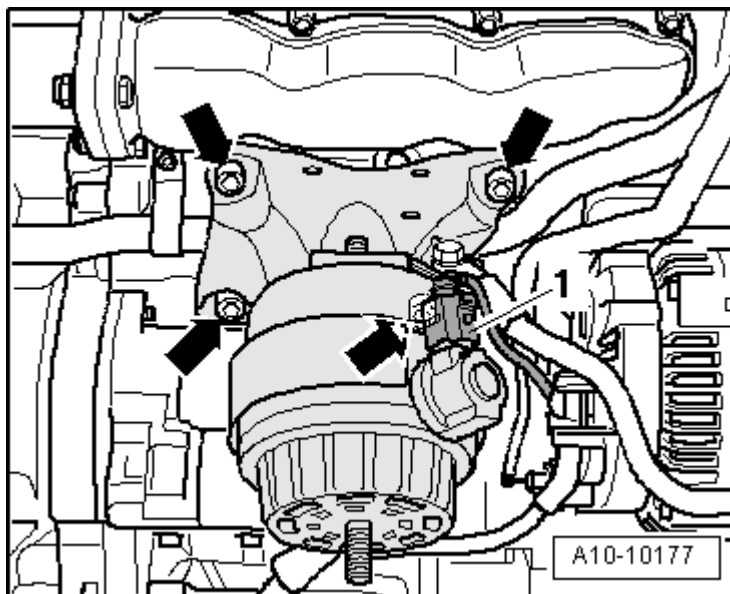

- Remove nut -arrow- and detach engine mounting from engine support.

### Installing

Installation is carried out in the reverse order; note the following:



#### Note

- ♦ *Renew the bolts tightened with specified tightening angle.*
- ♦ *Fit all cable ties in the original positions when installing.*
- Install subframe and anti-roll bar →Rep. gr.40.
- Install cover for drive shaft →Rep. gr.66.
- Fit front wheel →Rep. gr.44.
- Install air cleaner housing →Rep. gr.23.
- Observe notes on procedure for connecting the battery →Rep. gr.27.
- Tightening torques → Chapter

