

Removing and installing C-pillar trim

Special tools and workshop equipment required

- ♦ Torque wrench -V.A.G 1783-

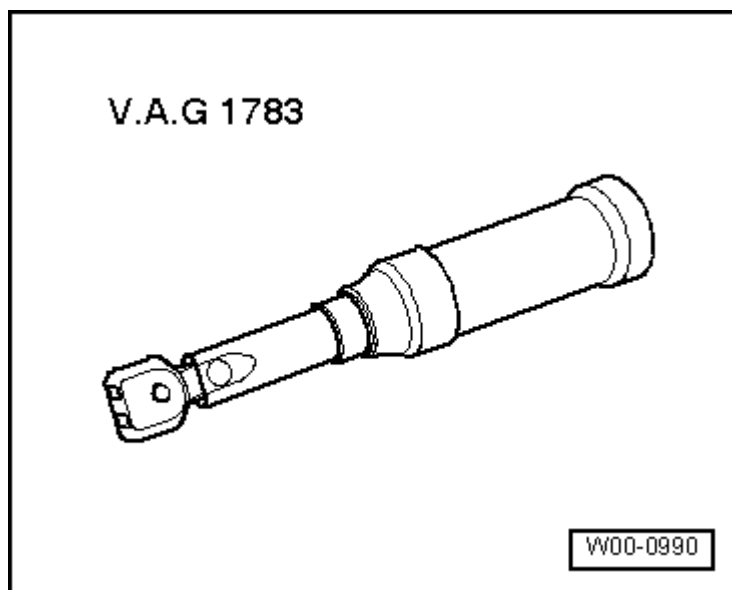

- ♦ Removal wedge -T40280- is needed to remove any clips left in body mounting points

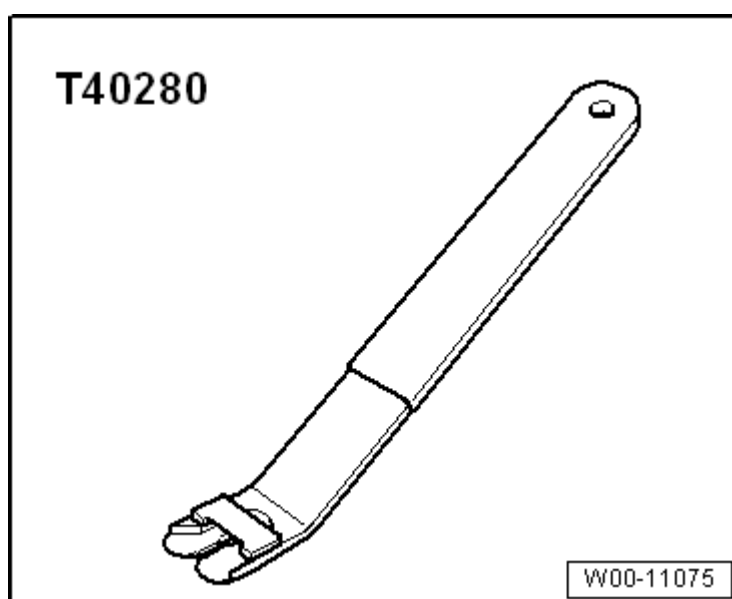

WARNING

Note safety precautions for working on curtain airbags → Chapter.

1 - C-pillar trim

- ♦ Removing
 - Remove roof end trim
→ Chapter.
 - Remove D-pillar trim
→ Chapter.

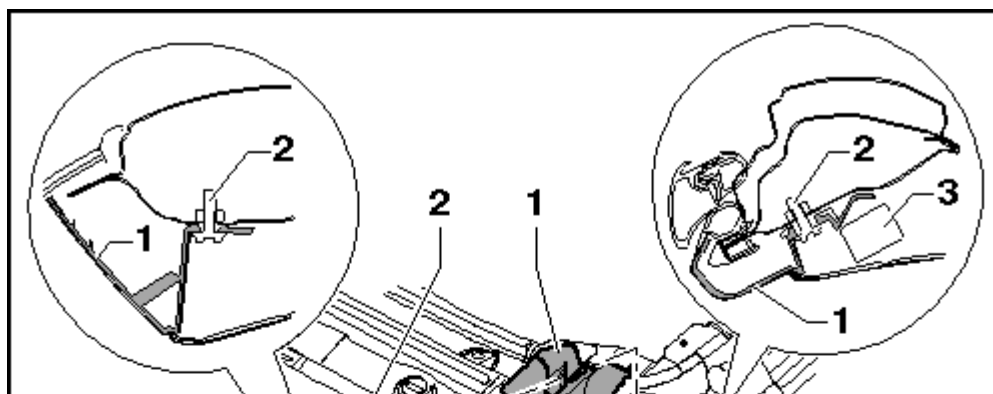

Vehicles with fixed rear seat backrest

- Remove rear seat backrest
→ Chapter.

Vehicles with folding rear seat backrest

- Remove side padding
→ Chapter.

All vehicles (continued)

- Detach rear shelf on the side in question.

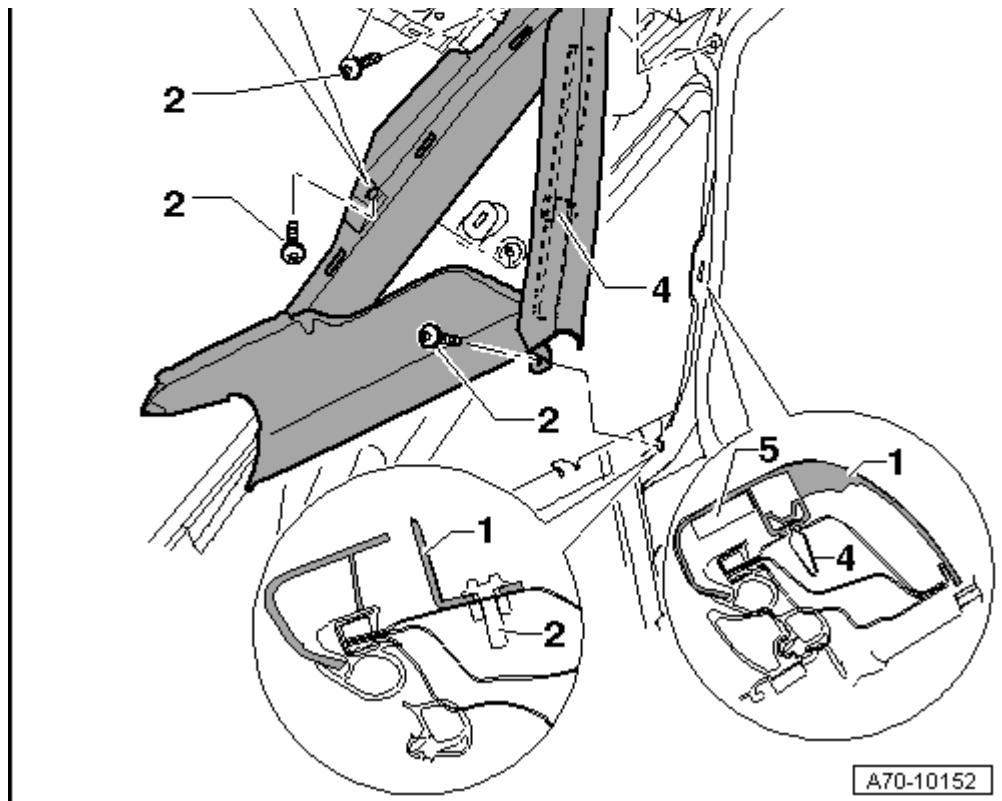

Rear shelf without sun blind → Chapter

Rear shelf with sun blind → Chapter

- Unscrew bolts -2- (3x).
- Unclip C-pillar trim -1- with clip -4-.
- Carefully pull C-pillar trim -1- out from underneath curtain airbag -3-.
- Release belt guide and slide it towards the rear as far as it will go → Fig..
- Pull C-pillar trim -1- out over seat belt.
- Detach C-pillar trim -1-.
- Remove any residue of locking fluid from threaded holes for bolts -2- (3x). To do so, you can use a thread tap.

If the threaded holes are not cleaned, there is a danger of the new bolts seizing when being screwed in and then shearing off the next time you try to remove them.

♦ Installing

- Check that clip -4- is not damaged or deformed.

If clip is damaged or deformed it must be renewed.

- Before fitting C-pillar trim -1- make sure that clip -4- is correctly positioned.



Note

Make sure that curtain airbag is not trapped or damaged when installing C-pillar trim -1-.

Adhere to correct sequence for installing C-pillar trim -1-:

- Carefully push upper section of C-pillar trim -1- under curtain airbag -3-.
- Secure C-pillar trim -1- with clip -4-.
- Screw in new bolts -2- and tighten to specified torque.
- Pull belt guide forwards as far as it will go and make sure it engages → Fig..

You should hear the retaining tab engage.

Make sure C-pillar trim -1- is securely engaged.

- Install rear shelf:
Rear shelf without sun blind → Chapter
Rear shelf with sun blind → Chapter

Vehicles with folding rear seat backrest

- Install side padding → Chapter.

Vehicles with fixed rear seat backrest

- Install rear seat backrest → Chapter.
- Install D-pillar trim → Chapter.
- Install roof end trim → Chapter.
- Fit lip of door seal over C-pillar trim -1-.

2 - Bolts, self-locking (3x)

- Tightening torque: 3.5 Nm
- Always renew after removing
- Threaded holes for bolts must always be cleaned (e.g. with a thread tap).

3 - Curtain airbag

4 - Clip

- Renew if damaged or deformed
- Remove any clips left in body mounting points using -T40280-

5 - Insulation

Disengaging and engaging belt guide



Note

Under no circumstances turn the bolts -2-. They have been set by the manufacturer.

Disengaging:

- Disengage belt guide -1-.
- To do so, push retaining tab upwards - arrow-.
- Slide belt guide -1- to rear as far as it will go.

Engaging:

- Pull belt guide -1- to the front as far as it will go.
- Make sure you hear retaining tab - arrow- click into place.



Note

The washers of bolts -2- should be located below the metal plate.

